

# Set-up Expand LinkWall

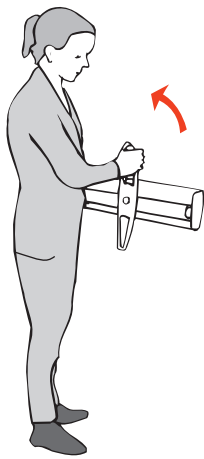

1



2

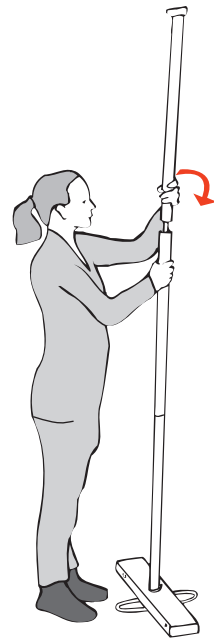

3



4

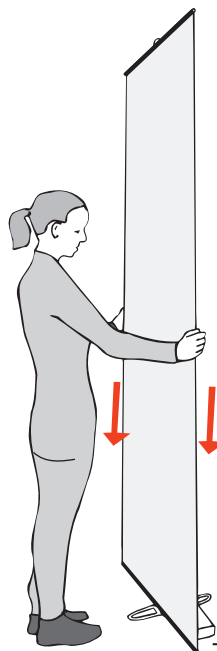

5

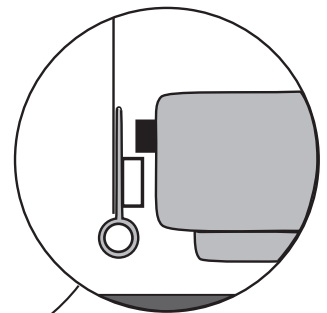

Magnetic lock

# Set-up with flex link panel

(for taller versions a ladder is recommended)

220 cm height

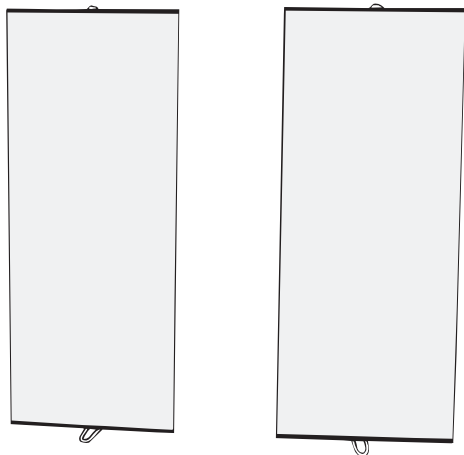

1

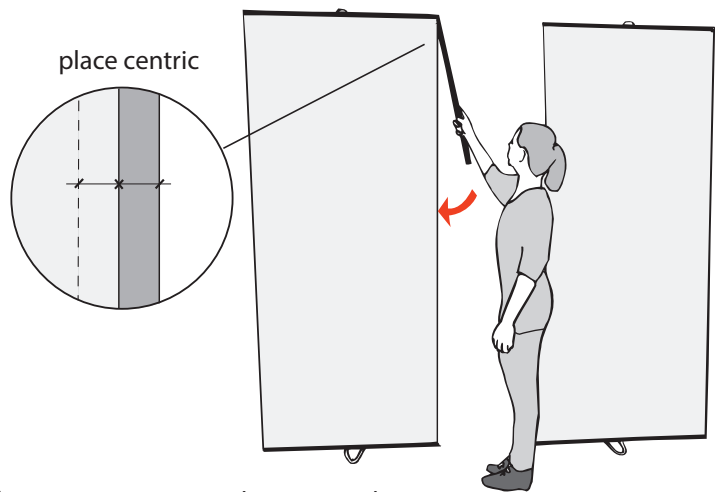

attach magnetic bars

2

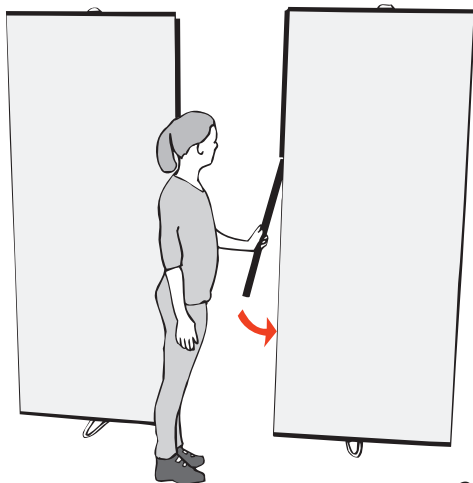

...along both panel sides

3

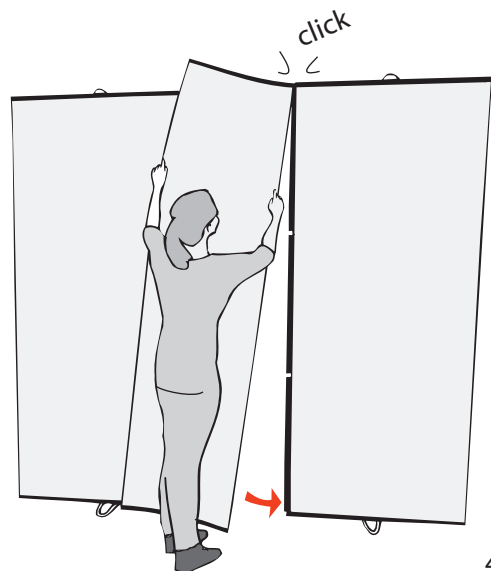

4

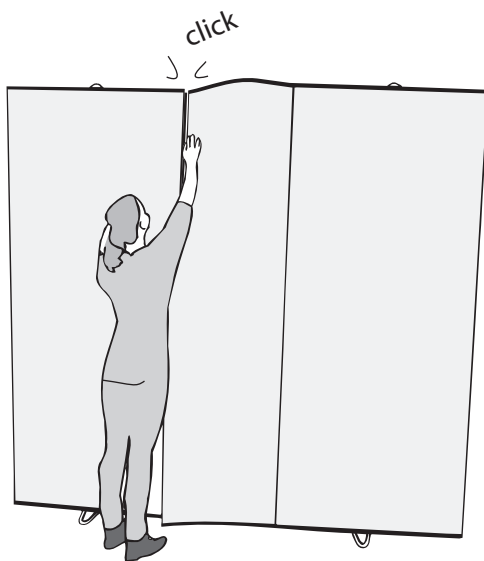

5



6

# Set-up without flex link panel

(for taller versions a ladder is recommended)

220 cm height

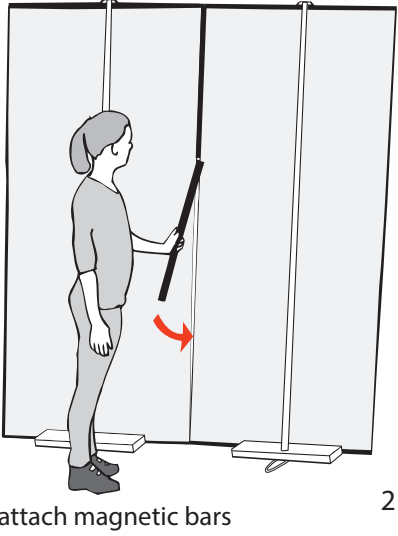
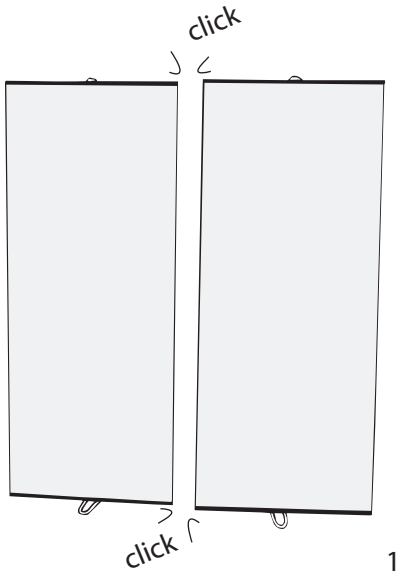

## How to attach end panel

for double sided unit

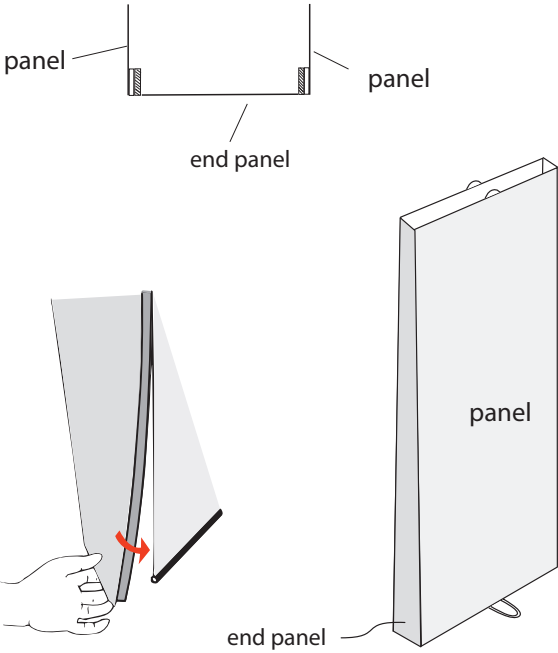

for single sided unit

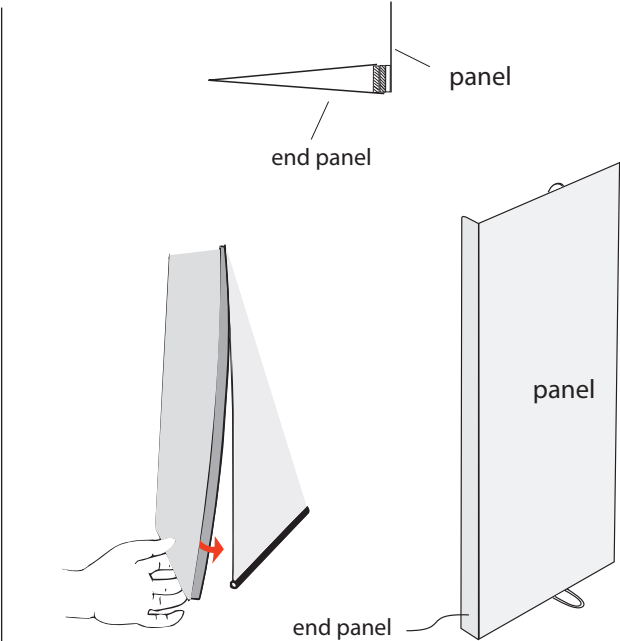

## How to align graphics

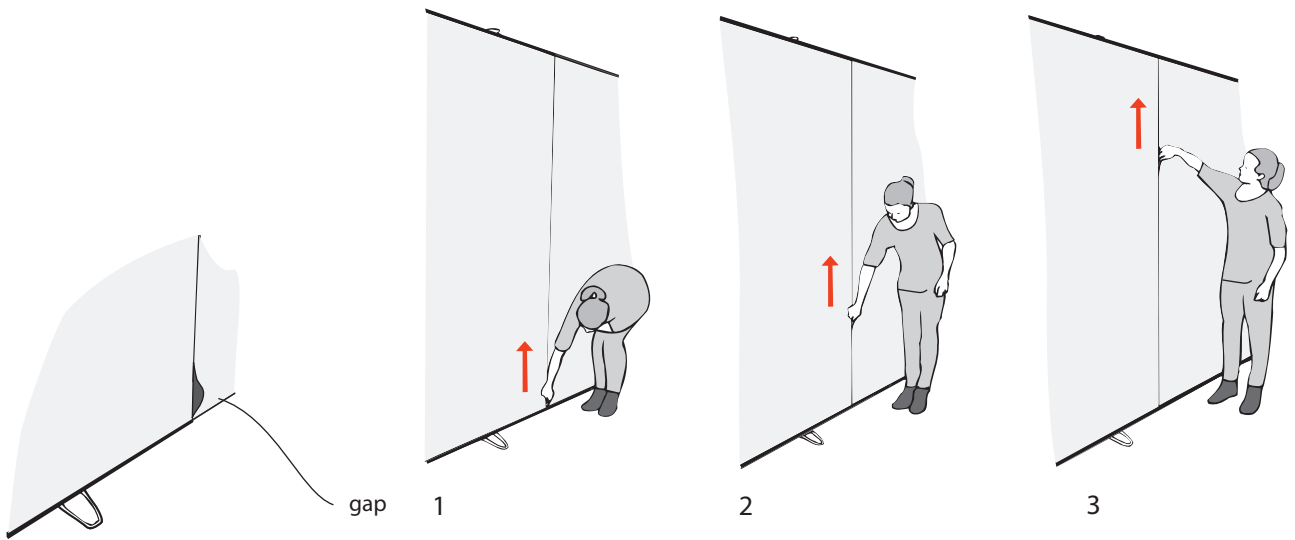

## Attaching spotlights

Expand Spotlight 50W

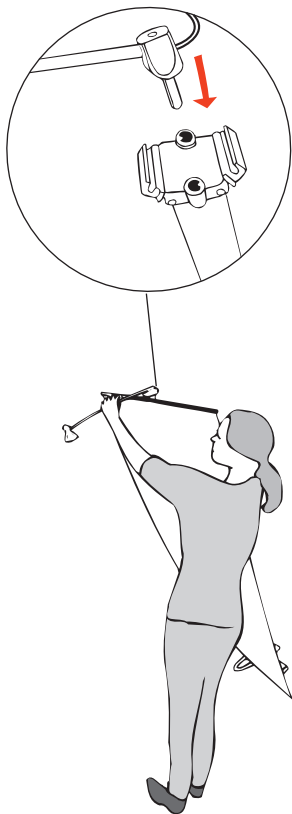

Expand Spotlight 150W/LED

